



Fireproof rolling shutters

BLOCKSHUTTER

EW120



BLOCKSHUTTER EW120

BLOCKSHUTTER EW120 has been designed and tested on both sides to keep the thermal radiation below of 15 kW/mq, in order to protect people and goods in the proximity, from heat radiation generated by fire.

BLOCKSHUTTER EW120 is composed of galvanized steel elements, 114 mm height and 22 mm thick. The door leaf has a weight of 30kg/mq.

The elements are securely hooked together and fastened on the side with steel end locks in order to prevent slipping and guarantee the uniform elements descent and if it is necessary, other special retain hooks can be applied to increase the resistance against the wind or internal vorteces that may occur.

A robust U profile with a thermo expanding gasket applied, complete the bottom element. The slats are infilled with highly performing silicate material that guarantee, after two hours of fire exposition in according to the fire test procedure reported on EN 1634-1, a detected radiation power not superior than 7KW/mq on the not exposed side (W performance)



1. Electric drive
» see characteristics pag.48
2. Main winding shaft
» see characteristics pag.47
3. Drive support bracket
4. Pression shaft
5. Lateral side guides
(standard)
» see characteristics pag.47
6. Door made with steel elements filled with insulated fireproof material.
» see characteristics pag.46
7. Control panel
» see characteristics pag.48
8. Anti drop
9. Support brackets



BLOCKSHUTTER EW120 is normally supply with a 400V three phase chain wheel drive – IP54 with Gravity fail safe system, that guarantee a controlled speed decent, even in case of power failure.

It is mandatory for the Gravity fail safe system, to install an acoustic and visual signal in accordig with EN 12604.

A back up battery is integrated in the control panel and in case of power failure, assure continuity of power supply to the magnetic brake, to avoid an unespected leaf's descent.

The control panel is set up for connection to the fire alarm, smoke or temperature detection system. An built-in keyboard with up/down/stop inputs is provided.

A 400 V three-phase drive with manual chain operation can be supplied as an alternative, with this motor type is mandatory to have an UPS (borne to the Customer) for the opening manouvre when the alarm activation occur.

The control panel (without back up battery) is arranged for connection to the fire alarm, smoke or temperature detection system. An built-in keyboard with up/down/stop inputs is provided.

Front wall fixation on the wall with threaded rods da Ø12, 450 Kg/m3 minimum wall density allow, 200 mm thickness.

On request: automatic operation, head box and Ral coating.

BLOCKSHUTTER EW120 is certified **WIND LOAD CLASS 2** in according to **EN 13241-1** and **CE MARKED** in according to **EN 16034:2014, EN 13241:2016**

INSTALLATION SCHEME / OVERALL DIMENSIONS

INSTALLATION SCHEME TYPE 1

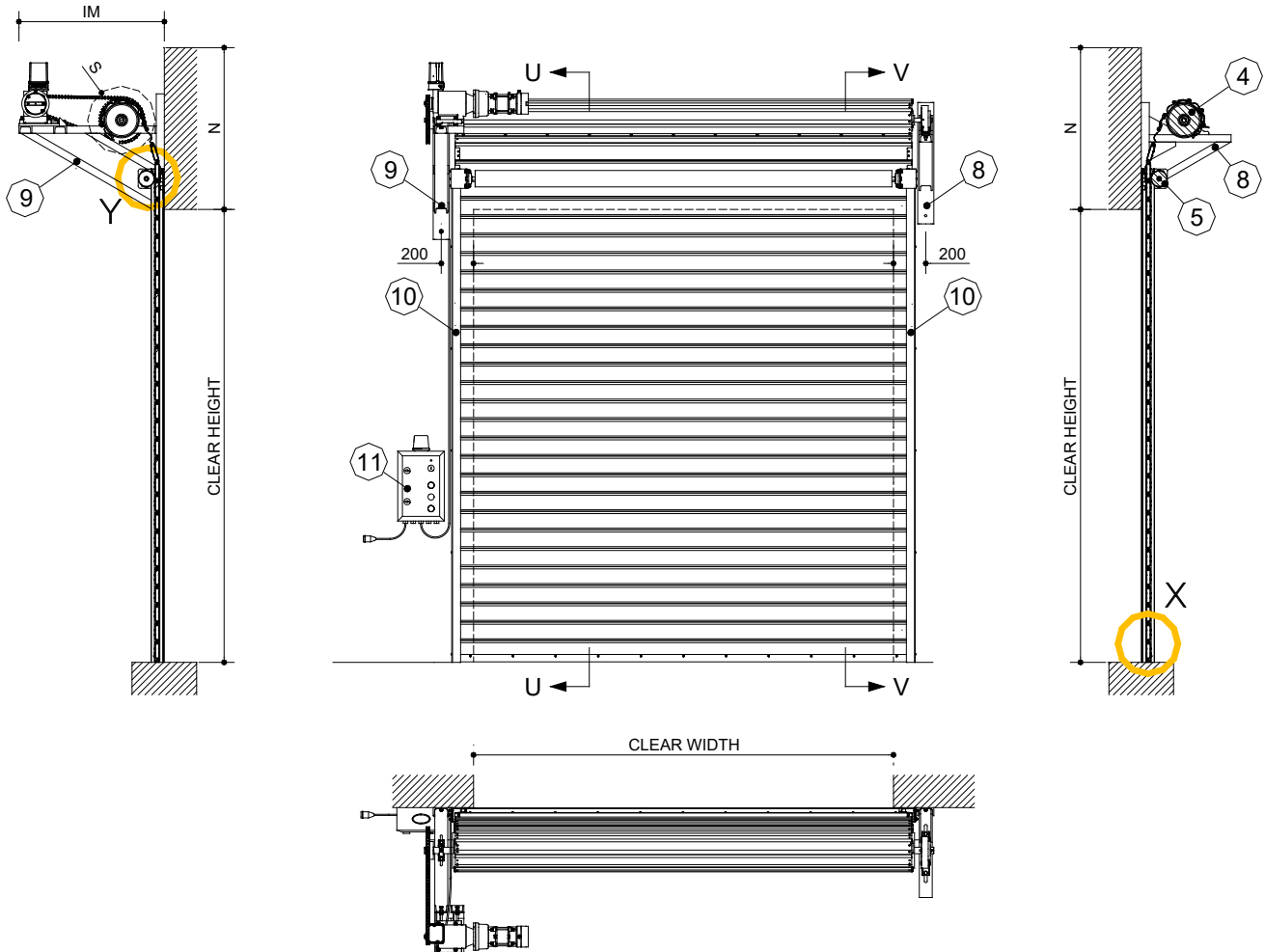

Components

- 05. Steel winding shaft
- 08. Steel support bracket antidrop system side
- 09. Three phase motor and transmission system support bracket
- 10. Lateral steel side guides filled with fire retardant insulated material and a layer of thermoexpanding gasket along the full height
- 11. Control panel with acoustic/visual signal set, preset to be connected to the general fire/smoke alarm system

Installation scheme Type 1

Drive and anti drop system support brackets fixed on the wall (front fixation)

Lateral side guides, fixed on the wall (front fixation) oltreluce)

Construction details

Y Detail

- 6. Labyrinth shaped profile in galvanized steel with thermo expanding sealing gasket along the total width.

X Detail

- 1. Galvanized steel element
- 2. Insulated fireproof material
- 3. "U" profile made of steel with thermo expanding sealing gasket

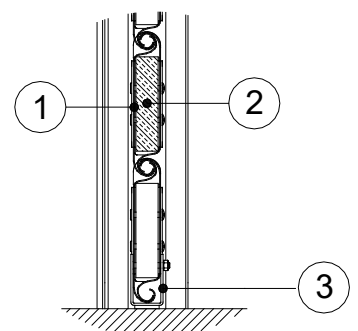
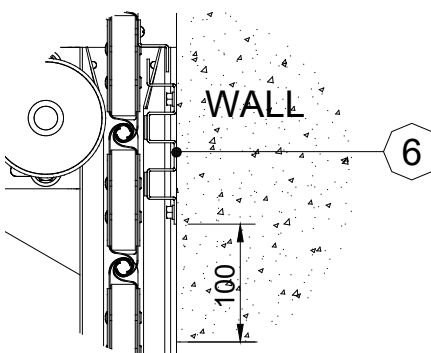

The support system consists of two sturdy steel brackets to which is inserted the winding shaft of 219 mm diameter on which the rolling shutter is wrapped. A pressure tube is positioned on the internal side, in the external side instead, there is a tubular with thermo expanding gaskets to seal and contain the flames. The frontal protection consists in a labyrinth system that joints the frontal tubular to the door leaf.

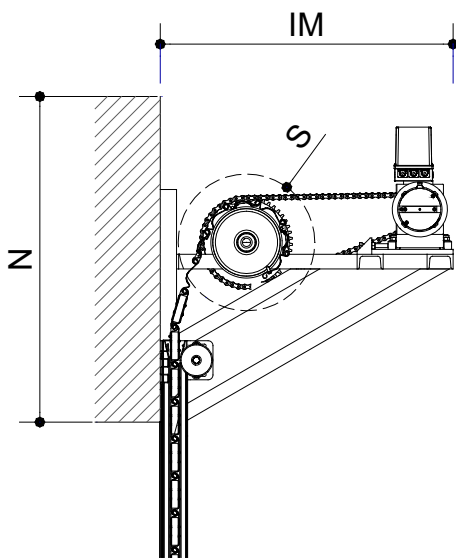

Overall dimensions

Clear height (mm)	N (mm)	S (mm)	IM (mm)
6000	950	630	1100
5500	930	600	1000
5000	920	570	1000
4500	900	540	1000
4000	880	510	1000
3500	860	480	900
3000	840	450	900
2500	830	420	900
2000	820	400	900

GENERAL CHARACTERISTICS/ LATERAL SIDE GUIDES

Lateral side guides are made of galvanized steel and are composed of two parts, the first is a sturdy bead of the dimension of 5.00mm to be fixed to the masonry, the second is a C shaped profile where the rolling shutter leaf slides. The side guides dimensions are 80 x 80 mm and must be installed 80mm from the width edge (valid within a rolling shutter's width of 6,00 mt)



upper view

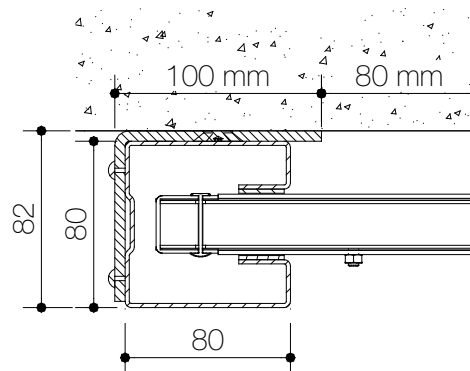

Front wall installation of side guide (valid dimensions upto L. 6.000 mm)

Guide type	Curtains dimensions max W. x H. (mm)	Guide dimensions max W. x D (mm)
GW80	up to 12.000 x 9.000 (front wall fixation)	80 x 80

Important: lateral side guides are mandatory

		FIRE-PROOF CHAIN DRIVERS FOR FIRE DOORS					
		MODEL					
		25-20	50-20	70-20	105-20	140-20	220-20
Drive torque	Nm	250	500	700	1050	1400	2200
Drive motor speed	min -1	20	20	20	20	20	20
Motor output	kW	0,55	1,1	1,5	2,2	3,0	4,0
Operating voltage	V	230/400/3 ~	230/400/3 ~	230/400/3 ~	230/400/3 ~	230/400/3 ~	230/400/3 ~
Mains frequency	Hz	50	50	50	50	50	50
Control voltage	V	24	24	24	24	24	24
Motor current rating	A	2,8/1,6	5,4/3,1	6,6/3,8	9,2/5,3	12,5/7,2	16,1/9,3
Max. cycles per hour *		30	30	30	30	30	30
Fuse protection, on site	A	10	10	10	10	16/10	20/10
IP protection class		54	54	54	54	54	54
Temperature range **	°C	-20/+60	-20/+60	-20/+60	-20/+60	-20/+60	-20/+60
Continuous sound pressure level	db (A)	<70	<70	<70	<70	<70	<70
Unit weight	kg	40	59	68	94	129	162
Maximum output revolutions		48	48	48	48	48	48

* One cycle corresponds to two door movements (opening and closing).

The specified values refer to 10 revolutions of the drive shaft per movement and presume an even distribution.

** Temperature range < -20°C: oil grade and electric heating on request.

CONTROL PANEL

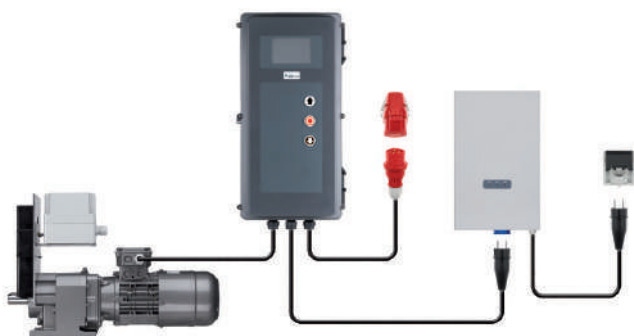

Operation

3-button input unit

LCD monitor with clear text display

3-button navigation / status and diagnostic messages

Integrated error memory (readout of all error messages including frequency and cycle of last occurrence)

Command Center CS310	Operating voltage	V	230 / 400 / 3 ~
	Mains frequency	Hz	50
	Control voltage	V	24
	Max. load	kW (A)	2,2 (8,0)
	Protection class		IP 65
	Temperature range	°C	-10/+40
	Dimensions, W x H x D	mm	245x455x190
	Unit weight	kg	1,8

UPS	Input voltage	V	230 / 1 ~
	Output voltage	V	230 / 1 ~
	Frequency	Hz	50
	Output	VA	500
	IP protection class		40
	Temperature range	°C	0 / +40
	Dimensions, W x H x D	mm	235x390x110
Unit weight	kg	11	